

Make a claim - examples of photos



Photograph 1. Depicts a close view of the footpath and clearly indicates the difference in height between the footpath and the adjacent nature strip. Consider other methods such as mobile phones, coins etc.



Photograph 2. An adult provides a point of reference regarding the length/size of a root mass removed from a private drain.

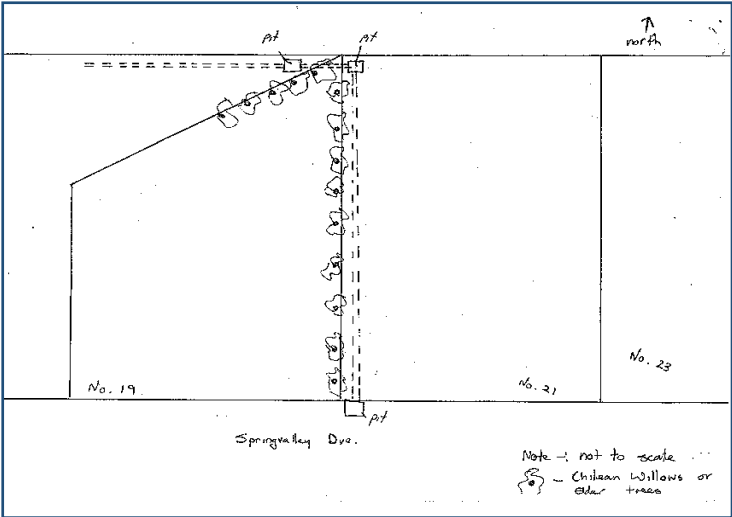

Figure 1. Sometimes a drawing can help explain the circumstances better than a photo



Photograph 3. Depicts a view of the subject street from a westerly direction.



Photograph 4. Depicts a view of the subject street looking towards the east